



Hannay Reels®

The reel leader.

Hannay Reels, Inc., 553 State Route 143
Westerlo, NY 12193
Telephone 518-797-3791 • Toll Free 1-877-GO-REELS (467-3357)
FAX 1-800-REELING (733-5464)
INT'L FAX (518) 797-3259
Website: www.hannay.com
E-mail: reels@hannay.com

ISO 224 PARTS LIST MODEL AVD - 3

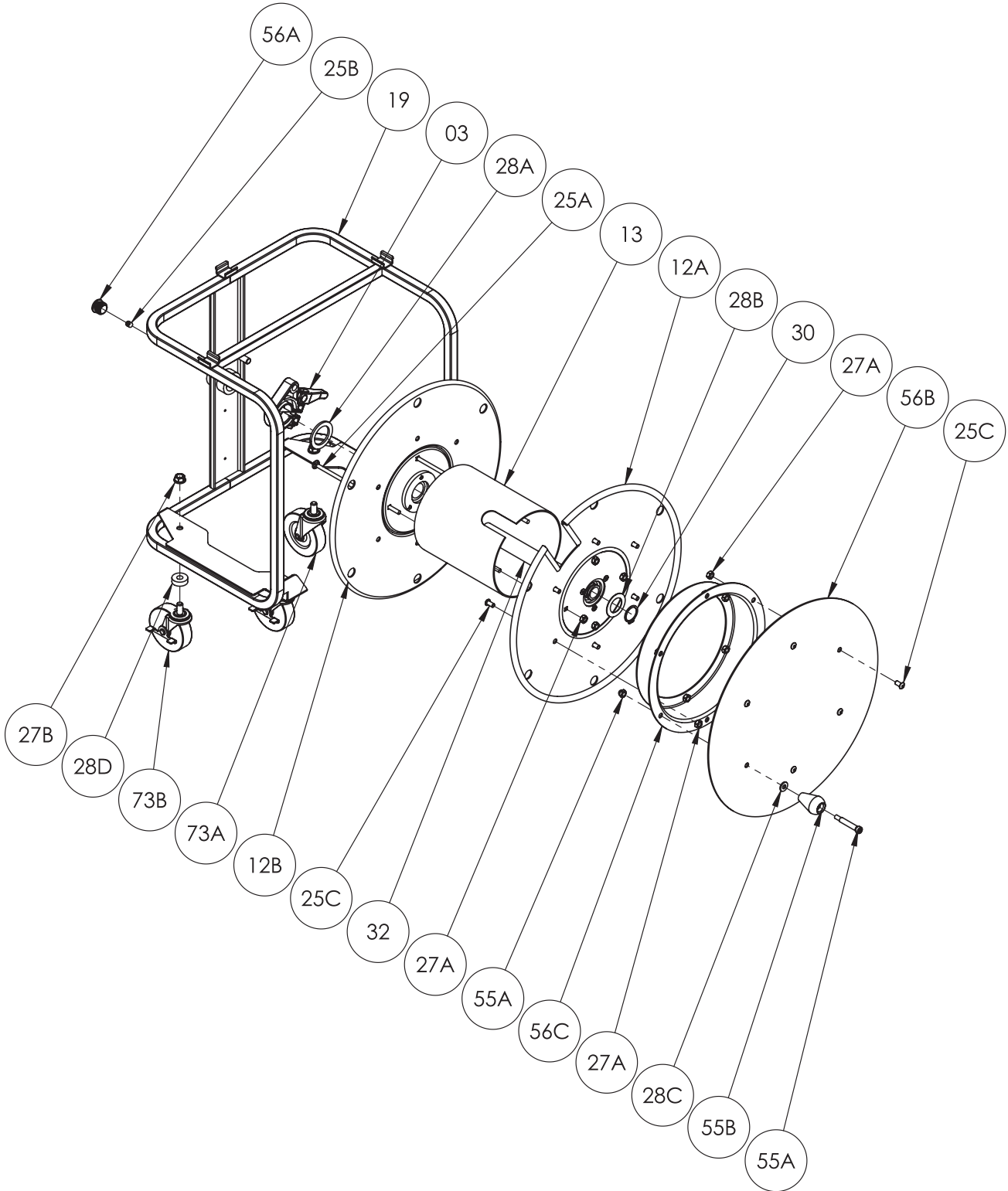

**PARTS LIST
ISO 224
MODEL AVD - 3**

When ordering parts

**BE SURE TO SPECIFY COMPLETE MODEL NUMBER and SERIAL NUMBER OF REEL.
USE PART NUMBER!**

<u>Item No.</u>	<u>Description</u>	<u>PART NUMBER</u>	<u>Quantity</u>
3	Cam Drag Brake, per A03A-00070	9947.0140	1
12A	Front Disc, 15" Dia., per A12A-00150	9949.0037	1
12B	Back Disc, 15" Dia., per A12A-00160	9949.0038	1
13	Drum, 6" Dia. (7" Length), per P13A-00040	9949.0021	1
19	AVD-3 Frame Assembly, per P19A-00130	9949.0015	1
25A	1/4"-20 x 8" Carriage Bolt	9949.0050	4
25B	5/16"-18 x 3/8" Allen Set Screw	9958.0007	2
25C	1/4"-20 x 1/2" Socket Head Cap Screw	9958.0058	11
27A	1/4"-20 Finish Hex Nut- Black Zinc	9958.0059	15
27B	3/8"-16 Spinlock Nut (Optional for Caster Assembly)	9904.6200	4
28A	1" Hub Spacer, 1-7/8" OD x 1-5/16" ID x 1/8" Thick Washer	9954.0021	1
28B	1" Spacer, 1-5/8" OD x 1" ID x 0.075" Thick Washer	9954.0035	1
28C	1/4" Flat Washer	9954.0005	1
28D	Spacer, 1" OD x 3/8" ID x 5/16" Thick (Optional for Caster Assembly)	9954.0017	4
30	1" External Retaining Ring	9951.0021	1
32	AVD-3 Hub, per P32A-00140	9949.0031	1
55A	5/16"-20 Shoulder Bolt w/ Acorn Nut	9914.0531	1
55B	Manual Rewind Knob Handle	9914.0565	1
56A	End Cap (CCF-7/8 14-20)	9958.0062	1
56B	Connector Enclosure Cover, Per P56A-00730	9955.1003	1
56C	Connector Enclosure	9949.0061	1
73A	2" OD Caster (Optional for Caster Assembly)	9949.0068	2
73B	2" OD Locking Caster (Optional for Caster Assembly)	9949.0069	2
73C	2" Caster Kit (Includes (2) 73A, (2) 73B, (4) 27B and (4) 28D) (Optional)	9949.0073	1