



Hannay Reels®

The reel leader.

Hannay Reels, Inc.
 553 State Route 143, Westerlo, NY 12193
 www.hannay.com
 Email: reels@hannay.com

Phone 1-518-797-3791
 Toll Free 1-877-GO-REELS (467-3357)
 Fax 1-800-REELING (733-5464)
 Int'l Fax 1-518-797-3259

ISO 88 PARTS LIST

**C 16-10-11, C 16-10-11-DE
 AVC 16-10-11, AVC 16-10-11-DE**
Portable Cable Reel

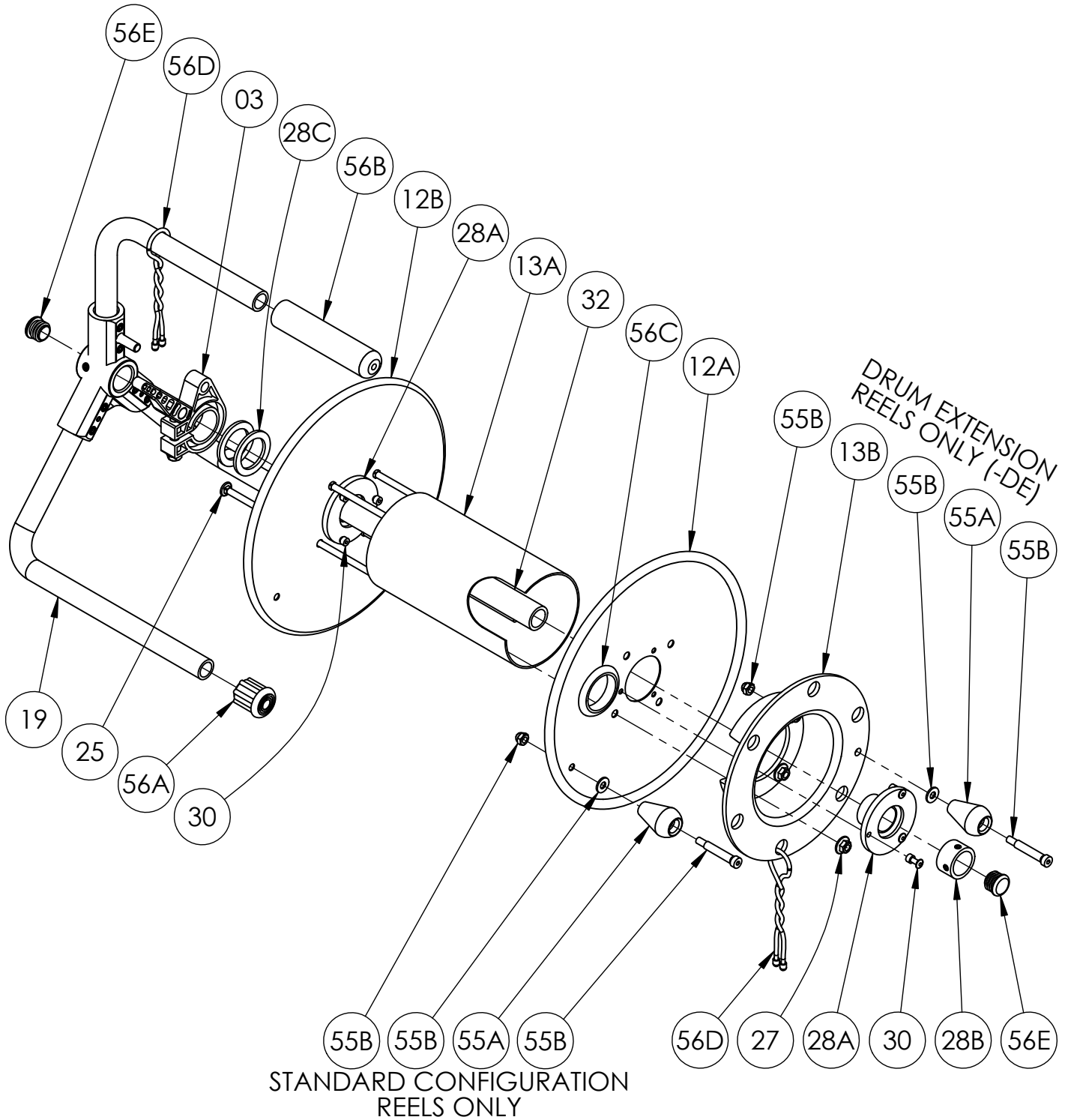

PARTS LIST
ISO 88
C 16-10-11, C 16-10-11-DE, AVC 16-10-11, AVC 16-10-11-DE

When Ordering Parts
BE SURE TO SPECIFY COMPLETE MODEL NUMBER and SERIAL NUMBER OF REEL
USE PART NUMBER!

<u>Item No.</u>	<u>Description</u>	<u>Part No.</u>	<u>Quantity</u>
03	Cam Lock Drag Brake Complete (see ISO-254 for parts).....	9947.0140	1
12A	C16-10-11 Front Disc, 18 GA (w/ Access Hole).....	9903.0111	1
12B	C16-10-11 Rear Disc, 18 GA (w/out Access Hole).....	9903.0111	1
13A	Drum, 4" Dia. Aluminum Pipe (Specify Model).....	9905.7105	1
13B	Plastic Cable Storage Drum (4.75" Dia.), per P13A-00260 (for -DE models only).....	9949.0300	1
19	Modular Portable Frame Assembly (see ISO-260 for parts).....	9906.0680	1
25	1/4"-20 x 8-1/4" Carriage Bolt w/ Nut (for -DE models only) (includes Item 27).....	9949.0052	4
25	1/4"-20 x 8" Carriage Bolt w/ Nut (Standard models only) (not shown).....	9949.0050	4
27	1/4"-20 Large Flange Spinlock Nut.....	9904.6002	4
28A	Delrin AV Disc Washer/Brake Arbor, per P28A-00930 (for C16-10-11 models).....	9949.0210	2
28A	Zinc/Aluminum AV Disc Washer/Brake Arbor, per P28A-00790 (for AVC16-10-11 models) (not shown).....	9949.0211	2
28B	Shaft Collar (1.31" O.D. x 1" I.D. x 0.75" Length) w/ Offset Set Screws, per P28A-00790.....	9955.0250	1
28C	1" Hub Spacer Washer - Plated (1-7/8" O.D. x 1-5/16" I.D. x 1/8" Thick).....	9954.0021	2
30	3/16" x 3/8" SST Blind Pop Rivet.....	9949.0212	6
32	Hub for C16-10-11 (304 SST), per P32A-00580.....	9955.0063	1
55A	Oval Knob Handle.....	9914.0565	1
55B	5/16" Shoulder Bolt, Washer & Nut (for Oval Knob).....	9914.0531	1
56A	Rubber Crutch Tip.....	9965.0058	2
56B	Rubber Hand Grip.....	9965.0057	1
56C	1-3/4" Rubber Grommet.....	9955.0030	1
56D	Black Gear Tie (12" Long).....	9949.0082	2
56E	End Cap (CCF-7/8 14-20).....	9958.0062	1 or 2