

ISO 121
PARTS LIST

C16-14-16, AVC16-14-16
C20-14-16, AVC20-14-16
(includes -DE models)

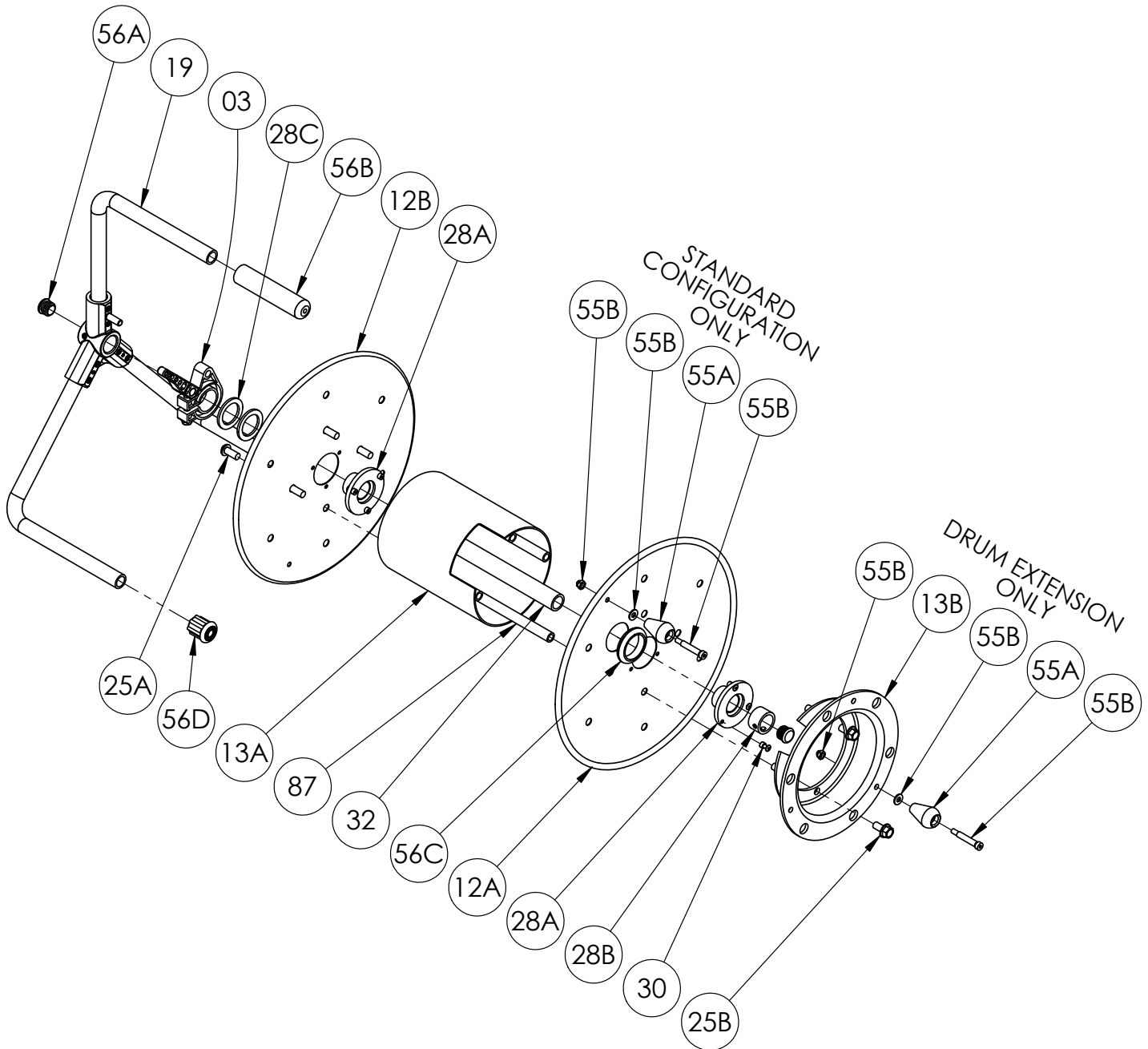

**PARTS LIST
ISO 121**

C16-14-16, AVC16-14-16, C20-14-16, AVC20-14-16 (includes -DE models)

**When Ordering Parts
BE SURE TO SPECIFY COMPLETE MODEL NUMBER and SERIAL NUMBER OF REEL
USE PART NUMBER!**

<u>Item No.</u>	<u>Description</u>	<u>Part No.</u>	<u>Quantity</u>
03	Cam Lock Drag Brake Complete (see ISO-254 for parts).....	9947.0140	1
12A	(14-16) 14" Dia. Disc, 18 GA Steel (w/ Access Hole), per P12A-00330	9903.0311	1
12B	(14-16) 14" Dia. Disc, 18 GA Steel, per P12A-00310.....	9903.0311	1
13A	Drum, 6" Dia., 7-1/2" Length (for C16-14-16), per P13A-00360.....	9905.7112	1
13A	Drum, 6" Dia., 12" Length (for C20-14-16), per P13A-00360 (not shown).....	9905.7112	1
13B	6-5/8" Dia. Plastic Cable Storage Drum, per P13A-00300 (for -DE models only).....	9949.0302	1
19	Modular Portable Frame Assembly (see ISO-260 for parts).....	Specify Model	1
25A	3/8"-16 x 7/8" Button Socket Head Cap Screw	9904.9201	4
25B	3/8"-16 x 3/4" Spinlock Bolt	9904.2201	4
28A	Delrin AV Disc Washer/Brake Arbor, per P28A-00930.....	9949.0210	2
28B	Shaft Collar (1-5/16" O.D. x 1" I.D. x 0.75" Length) w/ Offset Set Screw, per P28A-00790	9955.0250	1
28C	1" Hub Spacer Washer - Plated (1-7/8" O.D. x 1-5/16" I.D. x 1/8" Thick).....	9954.0021	2
30	3/16" x 3/8" SST Blind Pop Rivet.....	9949.0212	6
32	Hub for C16-14-16 (304 SST), per P32A-00390	9955.0063	1
32	Hub for C20-14-16 (304 SST), per P32A-00380 (not shown)	9955.0064	1
55A	Oval Knob Handle	9914.0565	1
55B	5/16"-20 Shoulder Bolt, Washer & Nut (for Oval Knob).....	9914.0531	1
56A	End Cap (CCF-7/8 14-20)	9958.0062	2
56B	Rubber Hand Grip	9965.0057	1
56C	1-3/4" Rubber Grommet	9955.0030	1
56D	Rubber Crutch Tip	9965.0058	2
56E	Black Gear Tie (12" Long) (not shown)	9949.0082	1 or 2
87	7-1/2" Long Anodized Aluminum Threaded Spacer Tube (for C16-14-16).....	9904.0315	4
87	12" Long Anodized Aluminum Threaded Spacer Tube (for C20-14-16) (not shown)	9904.0324	4