

**DESCRIPTION:**

This TSB details adjusting the rollers on an “N-series” spring reel to various positions.

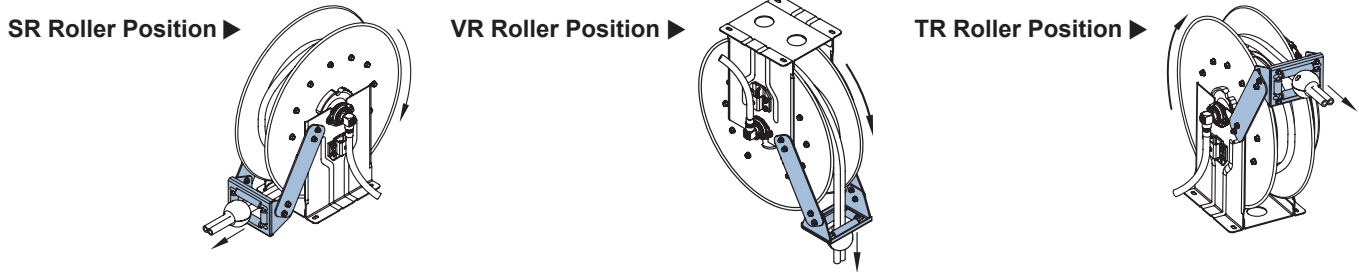

SPRING SIZE GUIDE		
Spring Type	Can Diameter “B”	Bolt Circle Diameter “A”
A	16.75”	19.12”
B	16.75”	19.12”
C	9”	10”
D	16.75”	19.12”
F	16.75”	19.12”
G	16.75”	19.12”
J	12.75”	13.38”
K	9”	10”
L	9”	10”
M	9”	10”
SA	16.75”	19.12”
SD	16.75”	19.12”

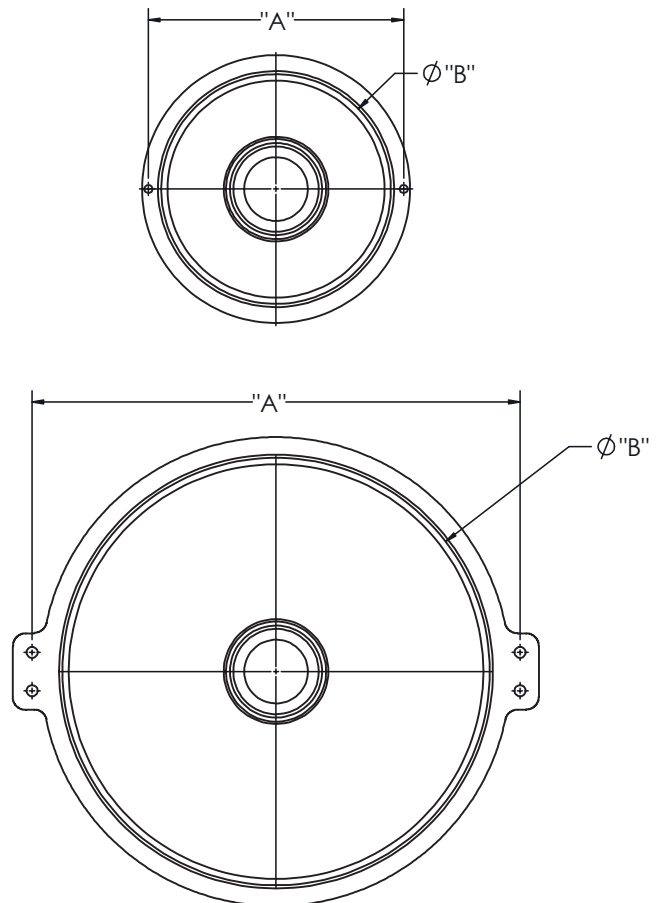

**INDEX:**

**Note:** In the following figures (pages 2-7), the spring mounting bracket and roller arms are highlighted by a different color, this for representation only.

Changing Roller Position from “SR” to “VR” with a “J, K, or M” Spring .....Page 2  
 Changing Roller Position from “SR” to “TR” with a “J, K, or M” Spring.....Page 3  
 Changing Roller Position from “SR” to “VR” with a “A, B, D, F, G, SA or SD” Spring .....Page 4  
 Changing Roller Position from “SR” to “TR” with a “A, B, D, F, G, SA or SD” Spring .....Page 5  
 Changing Roller Position from “SR” to “VR” with a “C or L” Spring .....Page 6  
 Changing Roller Position from “SR” to “TR” with a “C or L” Spring .....Page 7

## Changing Roller Position from “SR” to “VR” with a “J, K, or M” Spring:

1. Remove spring per Hannay TSB 2013.06.003 Changing a Hannay Spring Motor, this can be found at [www.hannay.com](http://www.hannay.com). The reel should look like Figure 1.

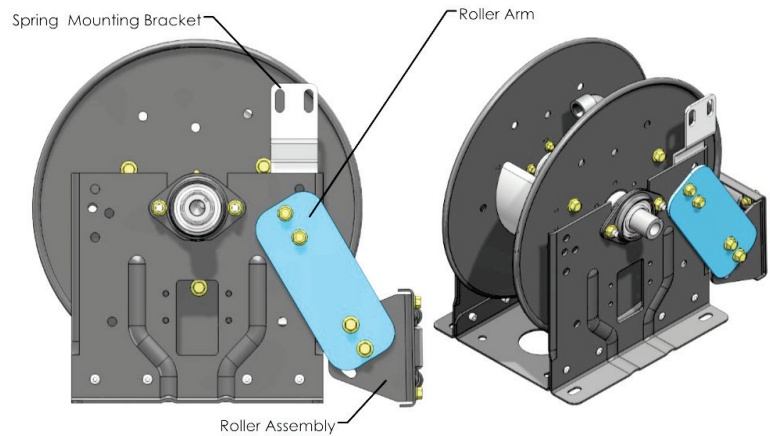

Figure 1 - Reel with Rollers in the “SR” Position

2. Make note of the spring bracket mounting location, which will be moved to the other side of the center hub.

3. Remove the 3/8” nuts and bolts holding the spring mounting bracket and roller arms to the frame.

4. Swing the Roller Bracket up to the VR position (Figure 2), until the holes on the bracket line up with the holes in the frame. Replace and tighten the bolts.

5. Reposition the spring mounting bracket as shown in Figure 2, using two 3/8”-16 x 0.75 spinlock bolts and two 3/8”-16 spinlock nuts. The reel should look like Figure 2.

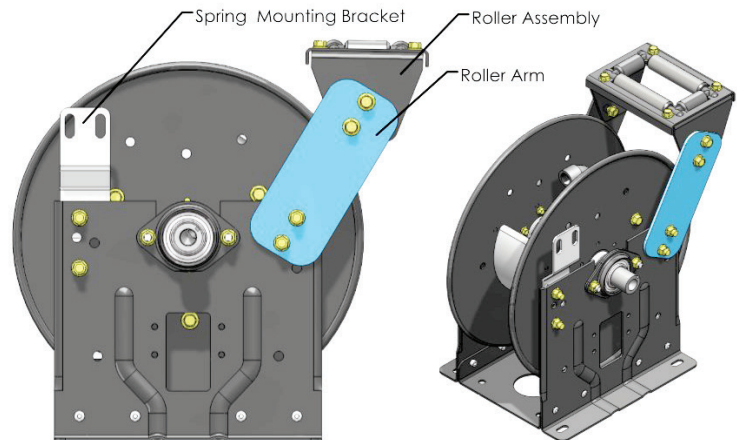

Figure 2 - Reel with Rollers in the “VR” Position

6. Remove the bottom bolts attaching the roller assembly to the roller arms and loosen the top bolts.

7. Rotate the roller assembly so that it is pointed in the same direction as shown in Figure 2.

8. Check that all bolts and nuts are tight.

9. Replace the spring per Hannay TSB 2013.06.003 Changing a Hannay Spring Motor.

10. To go from a “VR” to an “SR” simply reverse steps 1 – 9, discarding the bolts and nuts from step 5.

## Changing Roller Position from “SR” to “TR” with a “J, K, or M” Spring:

1. Remove spring per Hannay TSB 2013.06.003 Changing a Hannay Spring Motor, this can be found at [www.hannay.com](http://www.hannay.com). The reel should look like Figure 3.
2. Make note of the spring bracket mounting location so it can be reinstalled later.
3. Remove the 3/8” nuts and bolts holding the spring mounting bracket and roller arms to the frame.
4. Move the Roller Arms to the “TR” position (Figure 4) on the back side of the reel. Align the holes and install the bolts.
5. Reposition the spring mounting bracket as shown in Figure 4, using two 3/8”-16 x 0.75 spinlock bolts and two 3/8”-16 spinlock nuts. The reel should look like Figure 4.
6. Check that all bolts and nuts are tight.
7. Replace the spring per Hannay TSB 2013.06.003 Changing a Hannay Spring Motor.
8. To go from a “TR” to an “SR” simply reverse steps 1 – 7, discarding the bolts and nuts from step 5.

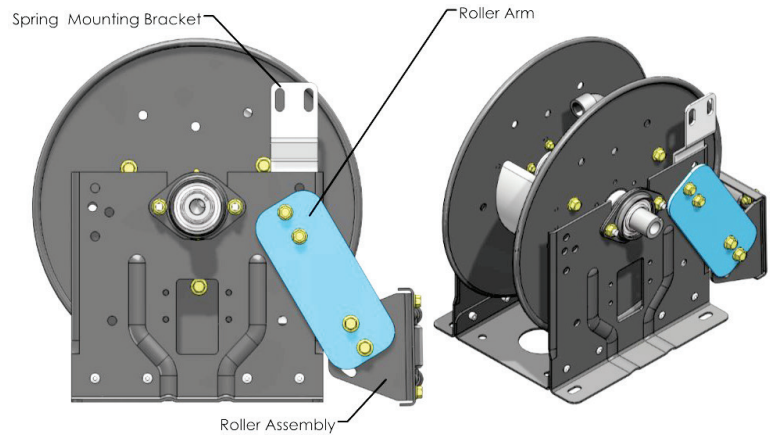

Figure 3 - Reel with Rollers in the “SR” Position

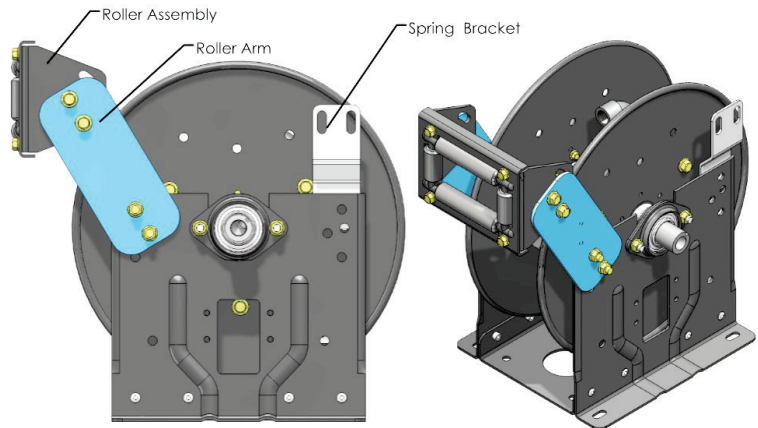

Figure 4 - Reel with Rollers in the “TR” Position

## Changing Roller Position from “SR” to “VR” with an “A, B, D, F, G, SA or SD” Spring:

1. Remove spring per Hannay TSB 2013.06.003 Changing a Hannay Spring Motor, this can be found at [www.hannay.com](http://www.hannay.com). The reel should look like Figure 5.
2. Make note of the spring bracket mounting location so it can be reinstalled later.
3. Remove the 3/8” nuts and bolts holding the spring mounting bracket and roller arms to the frame.
4. Swing the Roller Arms up to the VR position (Figure 6), until the holes on the roller and the spring brackets line up with the holes in the frame, replace and tighten the bolts.
5. Remove the bottom bolts attaching the roller assembly to the roller arms and loosen the top bolts.
6. Rotate the roller assembly so that it is pointed in the same direction as shown in Figure 6.
7. Check that all bolts and nuts are tight.
8. Replace the spring per Hannay TSB 2013.06.003 Changing a Hannay Spring Motor.
9. To go from a “VR” to an “SR” simply reverse steps 1 – 8.

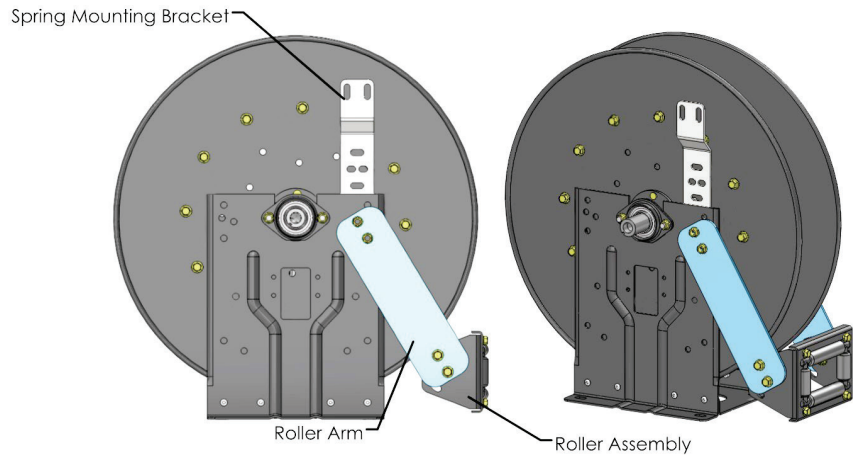

Figure 5 - Reel with Rollers in the “SR” Position

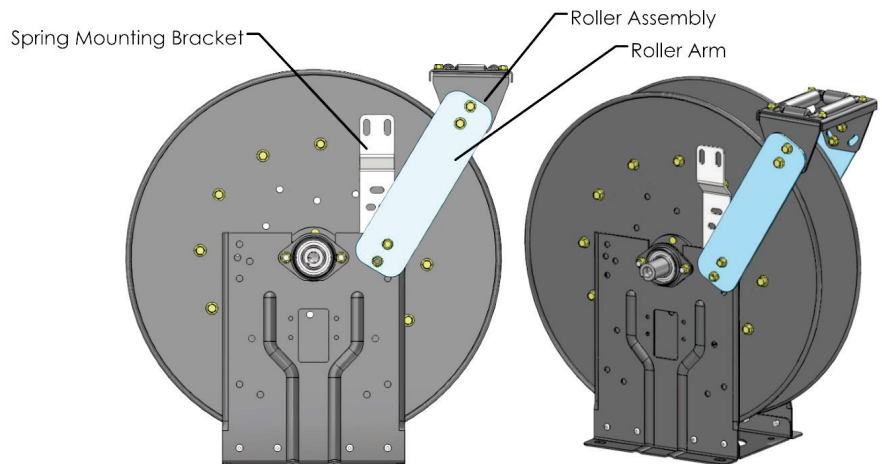

Figure 6 - Reel with Rollers in the “VR” Position

## Changing Roller Position from “SR” to “TR” with an “A, B, D, F, G, SA or SD” Spring:

1. Remove spring per Hannay TSB 2013.06.003 Changing a Hannay Spring Motor, this can be found at [www.hannay.com](http://www.hannay.com). The reel should look like Figure 7.
2. Make note of the spring bracket mounting location it can be reinstalled later.
3. Remove the 3/8” nuts and bolts holding the spring mounting bracket and roller arms to the frame.
4. Move the Roller Arms to the “TR” position (Figure 8) on the back side of the reel. Align the holes and install the bolts.
5. Reposition the spring mounting bracket as shown in Figure 8, using two 3/8”-16 x 0.75 spinlock bolts and two 3/8”-16 spinlock nuts. The reel should look like Figure 8.
6. Check that all bolts and nuts are tight.
7. Replace the spring per Hannay TSB 2013.06.003 Changing a Hannay Spring Motor.
8. To go from a “TR” to an “SR” simply reverse steps 1 – 7, discarding the bolts and nuts from step 5.

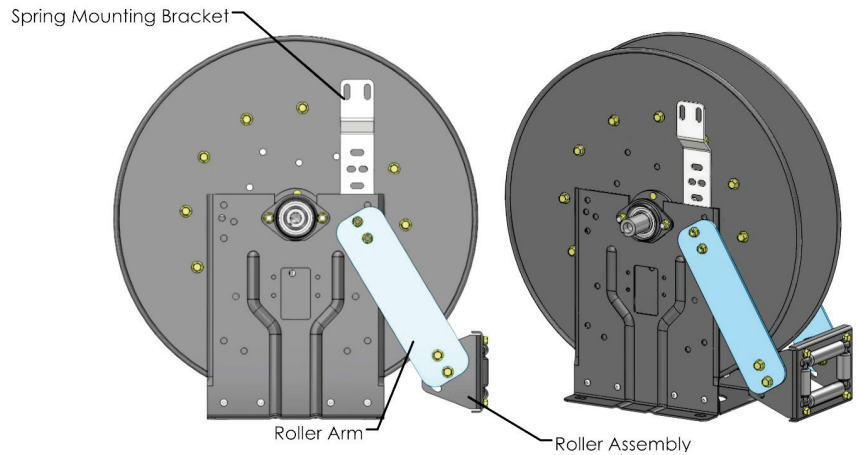

Figure 7 - Reel with Rollers in the “SR” Position

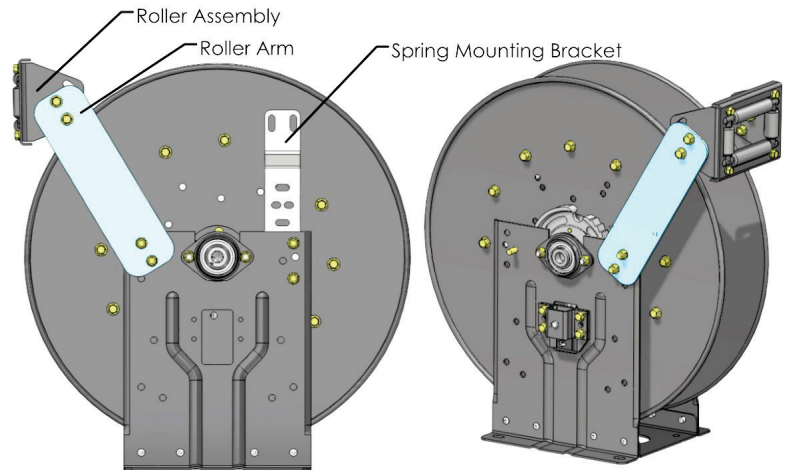

Figure 8 - Reel with Rollers in the “TR” Position

## Changing Roller Position from “SR” to “VR” with a “C or L” Spring:

1. Check if the arm holding the roller assembly to the frame is the same as in Figure 10. If you don't have the same arm you must order p/n 9941.0031.



Figure 9 - Old Style Roller Arm (9941.0030)

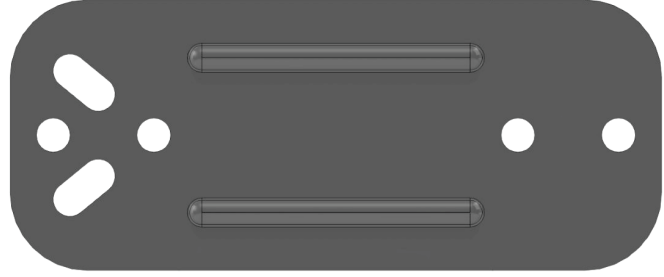

Figure 10 - New Style Roller Arm (9941.0031)  
Models Built after October 2013

2. Remove spring per Hannay TSB 2013.06.003 Changing a Hannay Spring Motor, this can be found at [www.hannay.com](http://www.hannay.com). The reel should look like Figure 11.
3. Remove the nuts and bolts holding the roller arms to the frame.
4. Swing the Roller Bracket up to the VR position (Figure 12) until the holes on the roller arms line up with the holes in the frame. Replace and tighten the bolts.

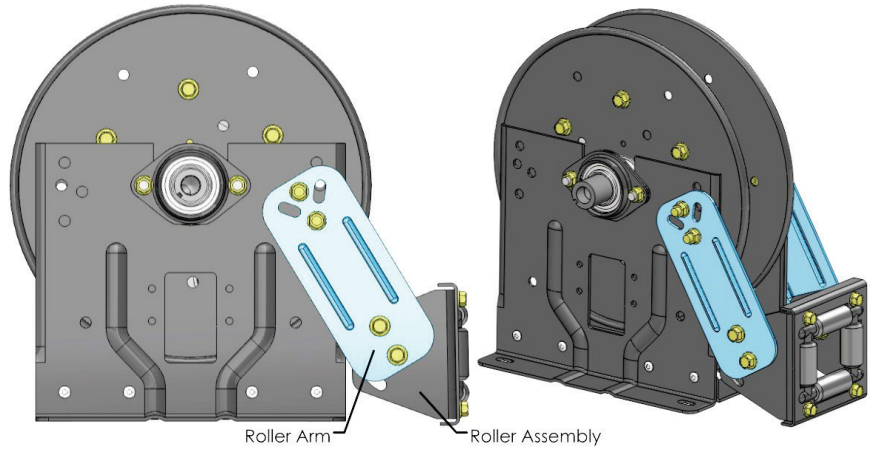

Figure 11 - Reel with Rollers in the “SR” Position

5. Remove the bottom bolts attaching the roller assembly to the roller arms and loosen the top bolts.
6. Rotate the roller assembly so that it is pointed in the same direction as shown in Figure 12.
7. Check that all bolts and nuts are tight.
8. Replace the spring per Hannay TSB 2013.06.003 Changing a Hannay Spring Motor.
9. To go from a “VR” to an “SR” simply reverse steps 1 – 8.

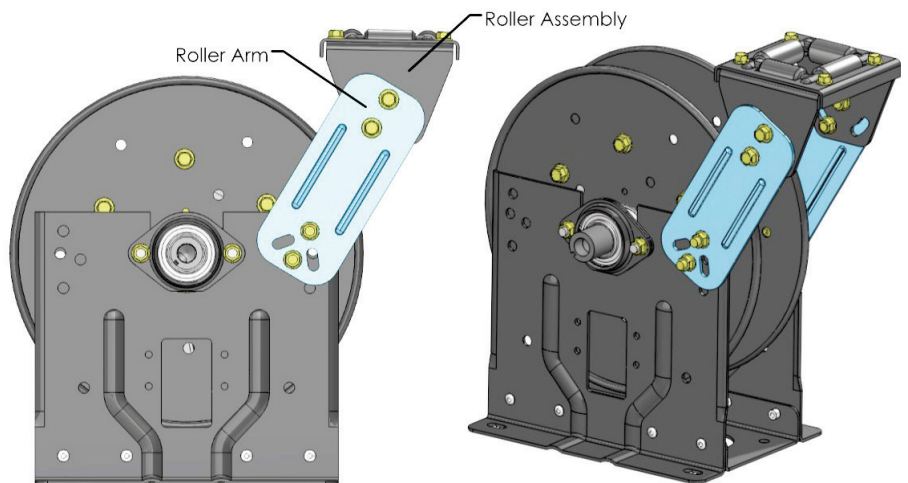

Figure 12 - Reel with Rollers in the “VR” Position

## Changing Roller Position from “SR” to “TR” with a “C or L” Spring:

1. Check if the arm holding the roller assembly to the frame is the same as in Figure 14. If you don't have the same arm you must order p/n 9941.0031.



Figure 13 - Old Style Roller Arm (9941.0030)



Figure 14 - New Style Roller Arm (9941.0031)  
Models Built after October 2013

2. Remove spring per Hannay TSB 2013.06.003 Changing a Hannay Spring Motor, this can be found at [www.hannay.com](http://www.hannay.com). The reel should look like Figure 15.
3. Remove the nuts and bolts holding the roller arms to the frame.
4. Move the Roller Arms to the “TR” position (Figure 16). On the back side of the reel, align the holes and install the bolts.

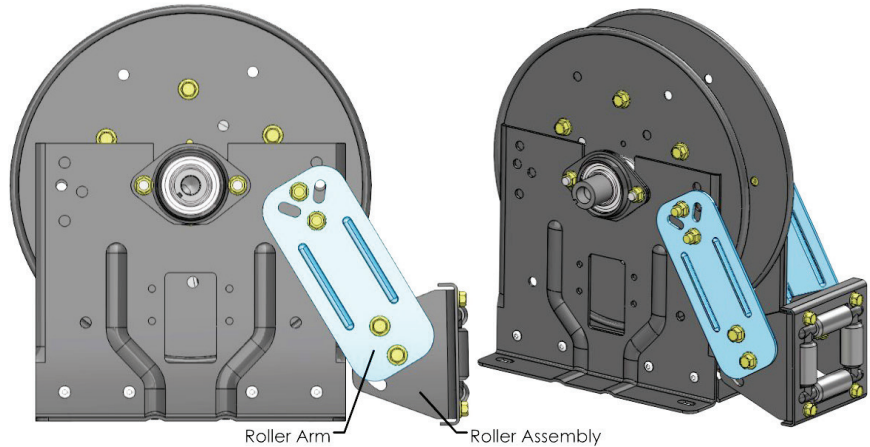

Figure 15 - Reel with Rollers in the “SR” Position

5. Rotate the roller assembly so that it is pointed in the same direction as shown in Figure 16.
6. Check that all bolts and nuts are tight.
7. Replace the spring per Hannay TSB 2013.06.003 Changing a Hannay Spring Motor.
8. To go from a “TR” to an “SR” simply reverse steps 1 – 8, discarding the two new bolts from step 5.

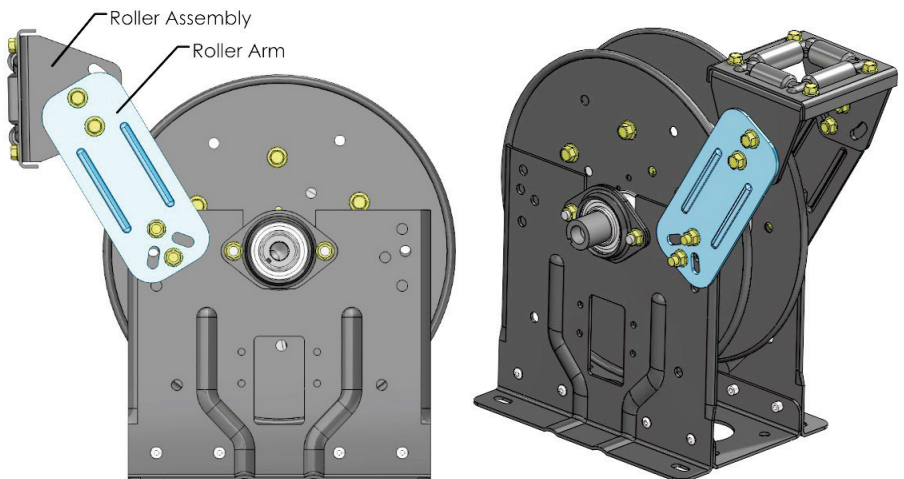

Figure 16 - Reel with Rollers in the “VR” Position